



Cordless Recipro Saw  
BJR181

Satisfy Professional's Needs



*Quicky*



**LXI**

**LITHIUM-ION**

**Cutting Speed**  
Cut through a 1" diameter steel pipe

Makita BJR181	153
Competitor "D"	116
Competitor "M"	100

←slow fast→  
The numbers in the charts are relative values when the capacity of Competitor "M" 's product is indexed at 100.



**Dust Preventing Air Flow**

**LED Job Light**



**5 position Shoe Adjustment**

**Large, Variable Speed Trigger**

**Sky Hook**



**Tool-less Blade Change**

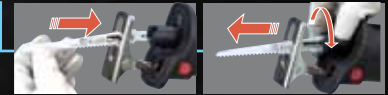

**Ergonomic Grip**

Best fitting to overhead application with gloved hand

**Cordless Recipro Saw**



- Variable Speed
- Electric Brake
- Carrying Case
- Built-in Job Light

● Fast Charger, Battery Cartridge (2 pcs.), Recipro Saw Blade Set

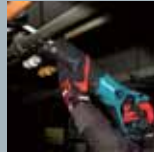

**18V 3.0Ah LITHIUM-ION**

**BJR181**

432

Capacity	in pipe : 130mm (5-1/8") in wood : 255mm (10")
Length of stroke	28mm (1-1/8")
Strokes per minute	0-2,900
Dimensions (L x W x H)	499 x 91 x 234mm (19-5/8" x 3-5/8" x 9-1/4")
Net weight	3.7 kg (8.1 lbs)
Voltage	18V

Items of standard equipment and specifications may differ from country to country.

**EXTREME STAMINA**

Life time work volume

**430%**

in comparison with Makita Ni-cd 2.0Ah batteries

Total Power Delivery Amount of each battery's service lifetime

	Li-ion 3.0Ah	430
	Ni-MH 3.0Ah	130
	Ni-cd 2.0Ah	100

The numbers in the chart are relative values when the amount of Ni-cd 2.0Ah is indexed at 100.

**LIGHTWEIGHT & COMPACT**

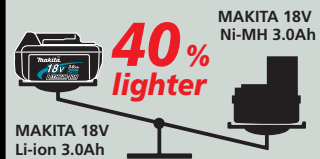

- ANYTIME CHARGE NO MEMORY EFFECT
- LONGTIME STORAGE
- LOW SELF DISCHARGE
- SHOCK ABSORBING HEAVY DUTY PACK
- FIRM HOLDING MULTI CONTACT

430% Only Achieved with...

**MAKSTAR Charger's Optimum Charging System**

- :: Communicates with individual battery.
- :: Recognizes ID of battery and its history.
- :: Analyzes its condition ; Battery may have been abused by heat or over-discharging, or weakened by cycle age.
- :: Charges optimum and gentle way with Active 3 Controls ;  
Active Current Control  
Active Thermal Control  
Active Voltage Control
- :: Knows how to look after each MAKSTAR battery to  
**MAXIMIZE CYCLE LIFE + WORK VOLUME.**

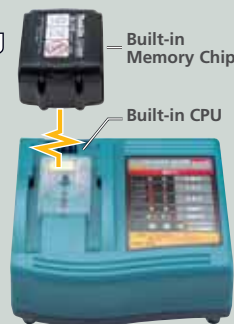

:: Cools down inside battery.

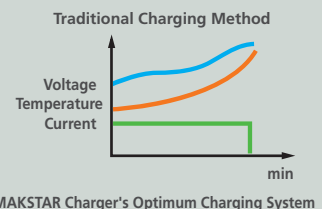

**Makita Corporation**

3-11-8, Sumiyoshi-cho, Anjo, Aichi 446-8502, Japan