



Recipro Saw  
JR3050T

***Powerful 9.0A motor increase  
cutting efficiency***



# Well balanced Tool design for better handling



## Performance Data

### • Comparison of cutting speed

Test conditions: Cut a piece of 2"x10" spruce timber and a 1" carbon steel pipe for plumbing with each supplied saw blade (for wood or for metal), and measured the time required.

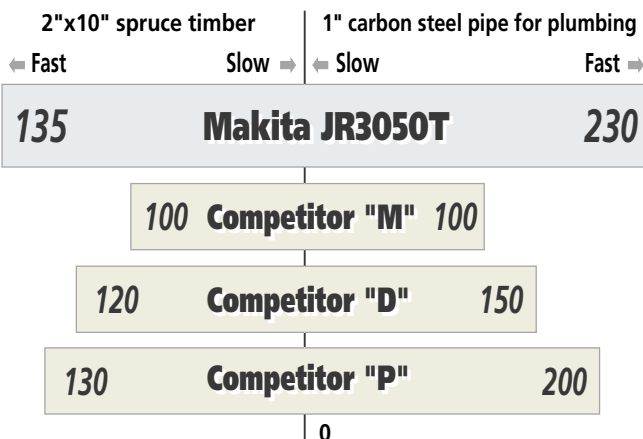

For Wood: Used Makita Blade No.23.

For Metal: Used the standard Blade of each Blade.

- The numbers in the charts above are relative values when the capacity of Competitor "M" is indexed at 100.
- The test results may differ under some conditions.

## Tool-less Blade Change

Push-in Lock System has made it possible to attach the blade quickly.

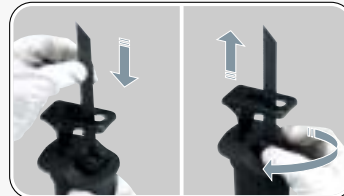

## Tool-less shoe Adjustment

Push the red button for adjusting shoe position.



## Dustproof and Dripproof Design

1. Front side of the slider is protected against saw-dust by;
  - 1) Air from the fan that sweeps saw-dust
  - 2) X ring and Felt that seal out saw-dust from the gear room
2. Gear room is also protected against water drops by a rubber seal ring.

## Soft Grip



## Large Trigger Switch



## SPECIFICATIONS

Continuous rating Input Capacity	1,010W
Length of stroke	in pipe : 90 mm (3-1/2") in wood : 90 mm (3-1/2")
Strokes per min.	28 mm (1-1/8")
Overall length	0-2,800
Net weight	452 mm (17-3/4")
Power supply cord	3.2 kg (7.1 lbs)
	2.5 m (8.2 ft.)

Specifications may differ from country to country.

## STANDARD EQUIPMENT

Recipro Saw Blade Set (No.21, 22, 23 : 1 each)

Items of standard equipment may differ from country to country.

## OPTIONAL ACCESSORIES

Please see. General Catalogue.