



Cordless Recipro Saw
BJR181

Satisfy Professional's Needs



Quicky



LXI

LITHIUM-ION

Cutting Speed
Cut through a 1" diameter steel pipe

Makita BJR181	153
Competitor "D"	116
Competitor "M"	100

←slow fast→
The numbers in the charts are relative values when the capacity of Competitor "M" 's product is indexed at 100.



Dust Preventing Air Flow

LED Job Light



5 position Shoe Adjustment

Large, Variable Speed Trigger

Sky Hook



Tool-less Blade Change

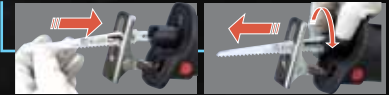

Ergonomic Grip

Best fitting to overhead application with gloved hand

Cordless Recipro Saw



- Variable Speed
- Electric Brake
- Carrying Case
- Built-in Job Light

● Fast Charger, Battery Cartridge (2 pcs.), Recipro Saw Blade Set

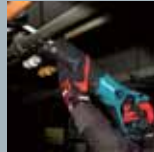

18V 3.0Ah LITHIUM-ION

BJR181

432

Capacity	in pipe : 130mm (5-1/8") in wood : 255mm (10")
Length of stroke	28mm (1-1/8")
Strokes per minute	0-2,900
Dimensions (L x W x H)	499 x 91 x 234mm (19-5/8" x 3-5/8" x 9-1/4")
Net weight	3.7 kg (8.1 lbs)
Voltage	18V

Items of standard equipment and specifications may differ from country to country.

EXTREME STAMINA

Life time work volume

430%

in comparison with Makita Ni-cd 2.0Ah batteries

Total Power Delivery Amount of each battery's service lifetime

	Li-ion 3.0Ah	430
	Ni-MH 3.0Ah	130
	Ni-cd 2.0Ah	100

The numbers in the chart are relative values when the amount of Ni-cd 2.0Ah is indexed at 100.

LIGHTWEIGHT & COMPACT

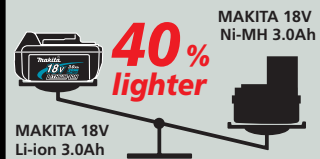

- ANYTIME CHARGE NO MEMORY EFFECT
- LONGTIME STORAGE
- LOW SELF DISCHARGE
- SHOCK ABSORBING HEAVY DUTY PACK
- FIRM HOLDING MULTI CONTACT

430% Only Achieved with...

MAKSTAR Charger's Optimum Charging System

- :: Communicates with individual battery.
- :: Recognizes ID of battery and its history.
- :: Analyzes its condition ; Battery may have been abused by heat or over-discharging, or weakened by cycle age.
- :: Charges optimum and gentle way with Active 3 Controls ;
Active Current Control
Active Thermal Control
Active Voltage Control
- :: Knows how to look after each MAKSTAR battery to
MAXIMIZE CYCLE LIFE + WORK VOLUME.

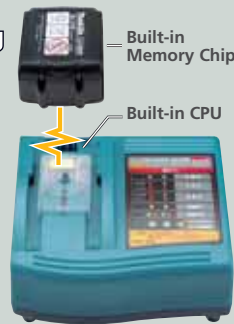

:: Cools down inside battery.

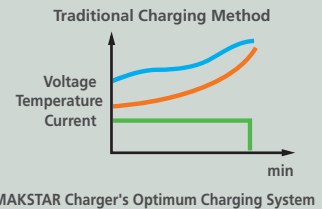

Makita Corporation

3-11-8, Sumiyoshi-cho, Anjo, Aichi 446-8502, Japan